

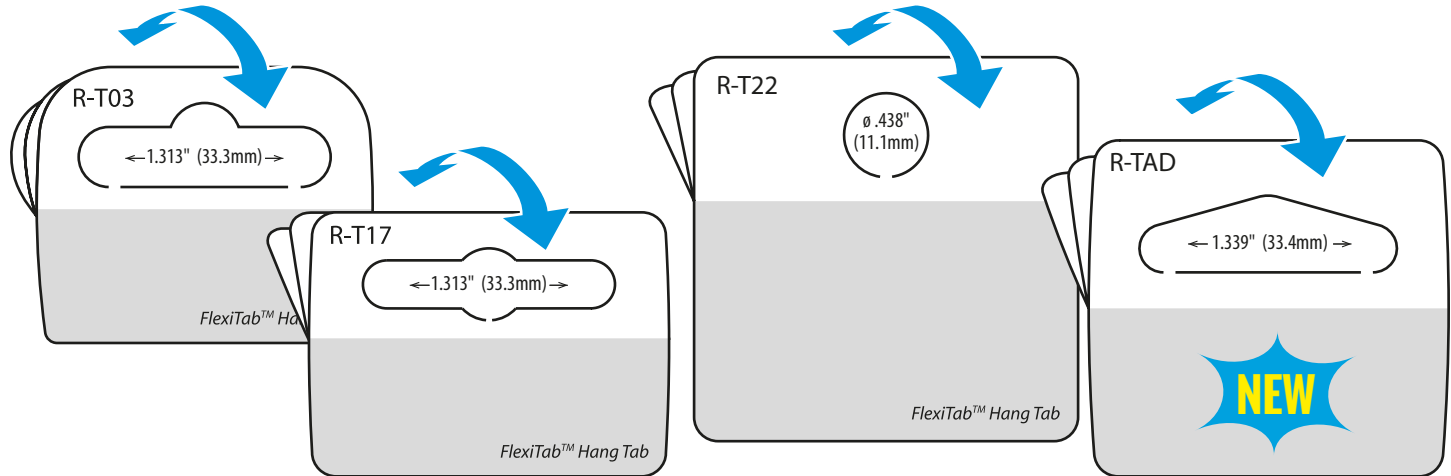

# FlexiTab™

THICKER, STRONGER HANG HOLE  
THINNER ADHESIVE AREA  
ADHERES TO CURVED, UNEVEN,  
OR UNIQUELY SHAPED PACKAGES

## FlexiTab™ Hang Tabs



R-T03	Imperial	Metric
Gauge:	10 mil	254 μ
Dimensions (W x H):	1.75 x 1.437in	44.5 x 36.5mm
Format:	3M / roll	
Package:	3 x 12in roll	7.6 x 30.5cm
Master Carton Quantity:	12M (4 rolls)	
Master Carton Weight:	17lb	7.7kg
Recommended Product Display Weight:	9oz	255g

R-T17	Imperial	Metric
Gauge:	10 mil	254 μ
Dimensions (W x H):	1.875 x 1.375in	47.6 x 34.9mm
Format:	4M / roll	
Package:	6 x 15.5in roll	15.2 x 39.4cm
Master Carton Quantity:	20M (5 rolls)	
Master Carton Weight:	28lb	12.7kg
Recommended Product Display Weight:	8oz	227g

R-T22	Imperial	Metric
Gauge:	15 mil	381 μ
Dimensions (W x H):	2 x 2in	50.8 x 50.8mm
Format:	3M / roll	
Package:	6 x 15.5in roll	15.2 x 39.4cm
Master Carton Quantity:	12M (4 rolls)	
Master Carton Weight:	31lb	14.1kg
Recommended Product Display Weight:	16oz	454g

R-TAD	Imperial	Metric
Gauge:	10 mil	254 μ
Dimensions (W x H):	1.875 x 1.75in	47.6 x 44.5mm
Format:	3M / roll	
Package:	3 x 12in roll	7.6 x 30.5cm
Master Carton Quantity:	12M (4 rolls)	
Master Carton Weight:	20lb	9.1kg
Recommended Product Display Weight:	10oz	283g

M = 1,000

M = 1,000

# Hang Tabs



FlexiTab™ Hang Tabs

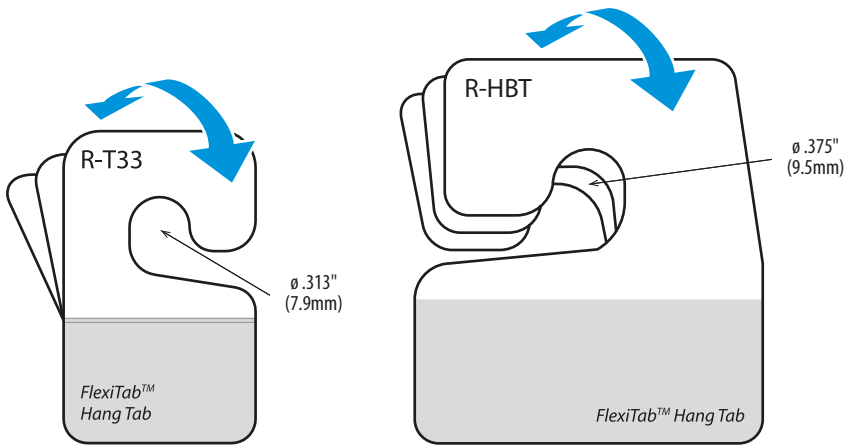

## R-T33

	Imperial	Metric
Gauge:	15 mil	381 μ
Dimensions (W x H):	1 x 1.625in	25.4 x 41.3mm
Format:	6M / roll	
Package:	6 x 15.5in roll	15.2 x 39.4cm
Master Carton Quantity:	24M (4 rolls)	
Master Carton Weight:	27lb	12.2kg
Recommended Product Display Weight:	8oz	227g

## R-HBT

	Imperial	Metric
Gauge:	20 mil	508 μ
Dimensions (W x H):	1.813 x 2in	46 x 50.8mm
Format:	2.25M / roll	
Package:	6 x 15.5in roll	15.2 x 39.4cm
Master Carton Quantity:	6.75M (3 rolls)	
Master Carton Weight:	24lb	10.9kg
Recommended Product Display Weight:	16oz	454g

M = 1,000

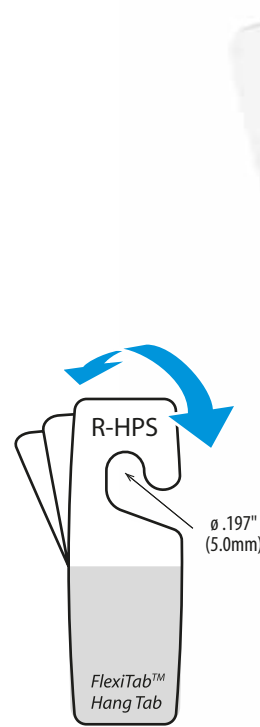

## R-HPS

	Imperial	Metric
Gauge:	10 mil	254 μ
Dimensions (W x H):	.591 x 1.688in	15 x 42.9mm
Format:	14M / roll	
Package:	6 x 15.5in roll	15.2 x 39.4cm
Master Carton Quantity:	42M (3 rolls)	
Master Carton Weight:	22lb	10kg
Recommended Product Display Weight:	5oz	142g

M = 1,000

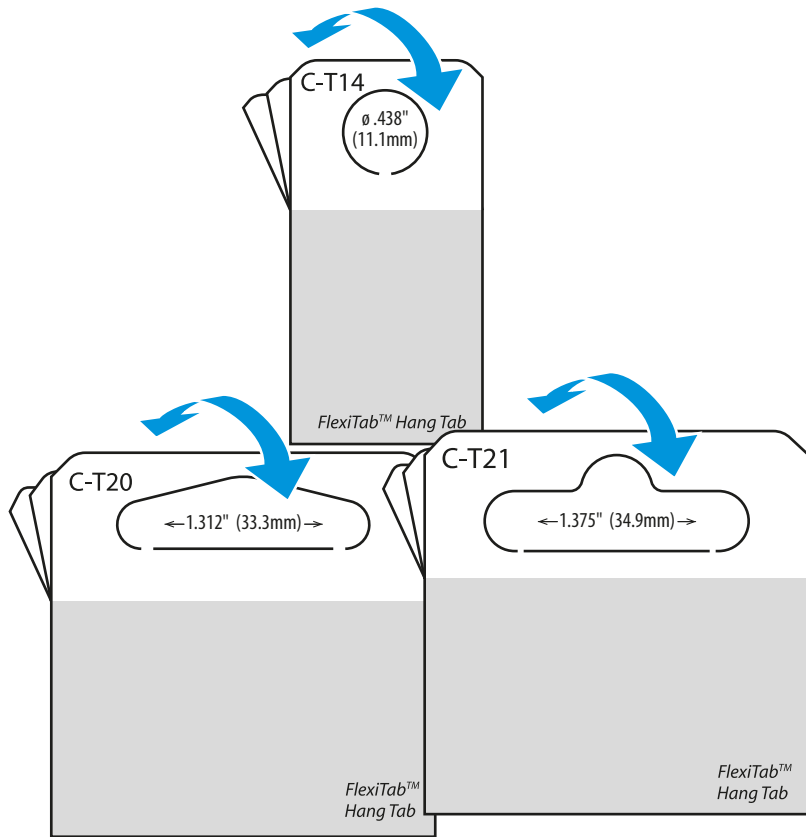

## C-T14

	Imperial	Metric
Gauge:	7.5 mil	190 μ
Dimensions (W x H):	1 x 2in	25.4 x 50.8mm
Format:	20 / sheet	
Package:	500/pack 5M/box	
Master Carton Quantity:	20M (4 boxes)	
Master Carton Weight:	18lb	8.2kg
Recommended Product Display Weight:	8oz	226g

## C-T20 / C-T21

	Imperial	Metric
Gauge:	15 mil	381 μ
Dimensions (W x H):	2 x 2in	50.8 x 50.8mm
Format:	10 / sheet	
Package:	500 pack	
Master Carton Quantity:	5M (10 packs)	
Master Carton Weight:	11lb	5kg
Recommended Product Display Weight:	10oz	283g

M = 1,000

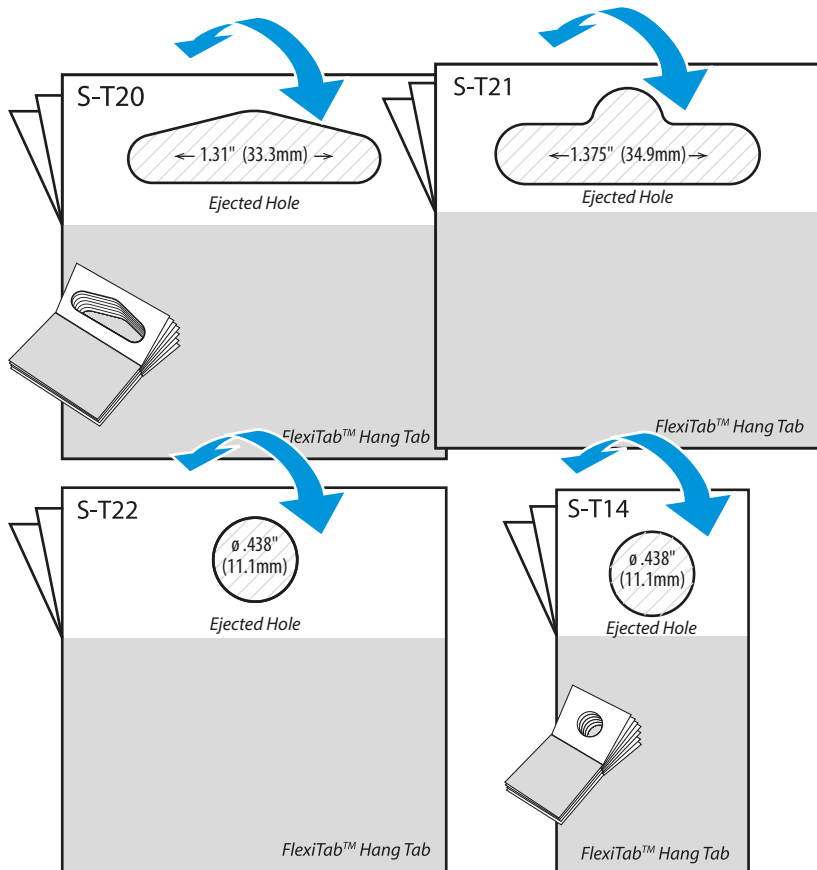

## S-T20/S-T21/S-T22

	Imperial	Metric
Gauge:	15 mil	381 μ
Dimensions (W x H):	2 x 2in	50.8 x 50.8mm
Format:	10 / pad	
Package:	50 pads/box	
Master Carton Quantity:	5M (10 boxes)	
Master Carton Weight:	9lb	4.1kg
Recommended Product Display Weight:	S-T20 / S-T21: 10oz	283g
	S-T22: 14oz	397g

## S-T14

	Imperial	Metric
Gauge:	15 mil	381 μ
Dimensions (W x H):	1 x 2in	25.4 x 50.8mm
Format:	10 / pad	
Package:	100 pads/box	
Master Carton Quantity:	10M (10 boxes)	
Master Carton Weight:	9lb	4.1kg
Recommended Product Display Weight:	9oz	255g

M = 1,000